

# Power highbay performance PHBP

Handleiding - Manuel d'installation - Installation instructions  
100W/150W/200W/240W



AUB LEES DEZE INSTRUCTIES VOOR DE INSTALLATIE  
VEUILLEZ LIRE CES INSTRUCTIONS AVANT L'INSTALLATION  
PLEASE READ THESE INSTRUCTIONS BEFORE INSTALLATION



# INSTALLATION

1. Turn off power at electrical panel.



2. Determine mounting position and mark placement for hook. Drill pilot holes for anchors.

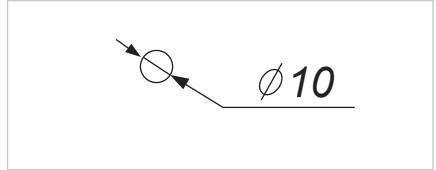

3. Secure the hook by tightening the nut.

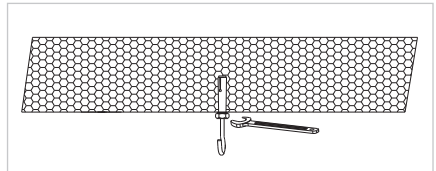

4. Hang the fixture on the hook.

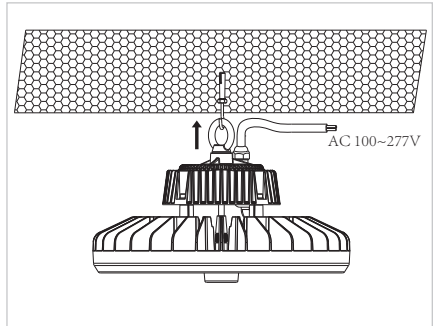

5. Connect the fixture to the power line.

## 120V & 277V

GROUND	○	GREEN(YELLOW/GREEN)
NEUTRAL	○	WHITE(BLUE)
LINE (HOT)	○	BLACK(BROWN)

## 240V

GROUND	○	GREEN
LINE 1 (HOT)	○	WHITE
LINE 2 (HOT)	○	BLACK

6. Turn on the power and you are done.

**IF THE PRODUCT YOU BOUGHT THAT INCLUDING DIMMING FUNCATION.  
READ THE FOLLOWINGS.**

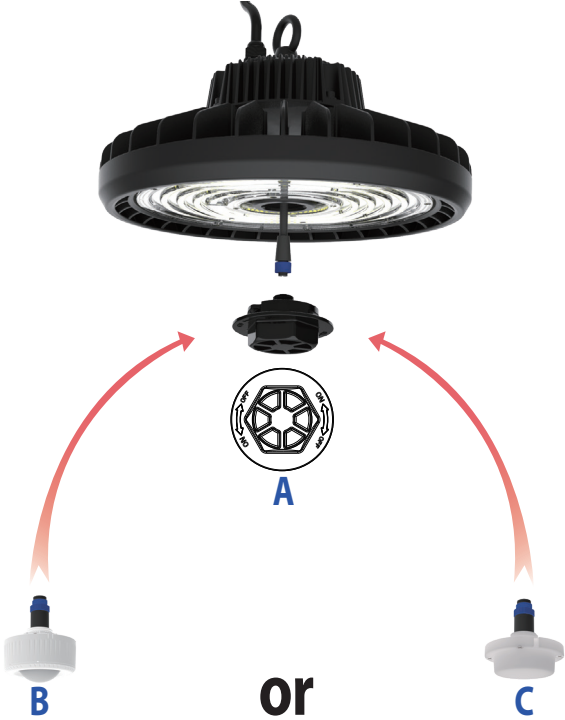

- ①According to the direction of the silkprint on the surface of the screw cover (A), unscrew the cover, pull out the dimming line.The cover is not a sensor.
- ②Unscrew the cover with the dimming line,there are two sections you can choose:
  - connect the PIR sensor (B) and the dimming line;
  - connect the microwave sensor (C) and the dimming line
- ③All the sensors can be controlled by remote.